



圖例
LEGEND

收地 / 清拆界限
RESUMPTION / CLEARANCE LIMIT

將予收回的農地
AGRICULTURAL LAND TO BE RESUMED

刪除收地範圍
DELETION OF LAND RESUMPTION AREA

地段界線
LOT BOUNDARY

D.D. 丈量約份
DEMARCATIION DISTRICT

FSSTL 粉嶺上水市地段
FANLING SHEUNG SHUI TOWN LOT

G.L. 政府土地
GOVERNMENT LAND

RP 餘段
REMAINING PORTION

S. 分段
SECTION

橙色綴黑網點
ORANGE STIPPLED BLACK

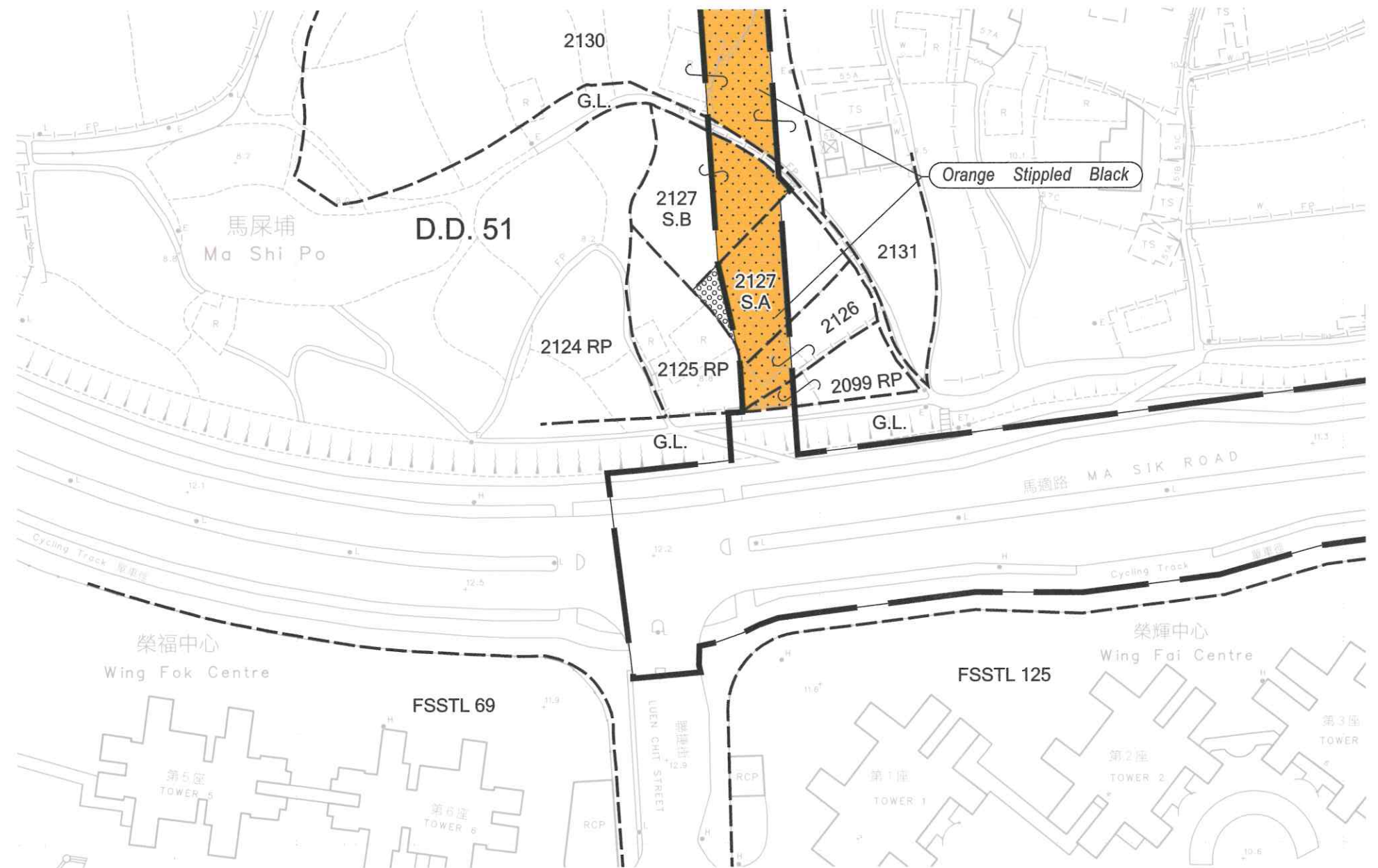

縮小在丈量約份第51約地段第2127號A分段收地的範圍至257.2平方米(約數) / 2768平方呎(約數)
Reduction of the scale of resumption for Lot No. 2127 S.A in D.D. 51 to 257.2 m² (about) / 2768 ft² (about)



只作識別用
FOR IDENTIFICATION PURPOSES ONLY

(趙莉莉 CHIU Lee-lee, Lily)
總產業測量師 / 土地徵用 Chief Estate Surveyor / Acquisition
日期 Date 21.9.2018

地政總署 工程項目組
Projects Section
Lands Department
圖則由測繪處工程項目測量小組繪製
Plan Prepared by Projects Survey Unit, Survey and Mapping Office
© 香港特別行政區政府 版權所有 Copyright reserved - Hong Kong SAR Government

修改收地圖則
道路 (工程、使用及補償) 條例 (第 370 章)
工務計劃項目第 7747CL 號
古洞北新發展區及粉嶺北新發展區
前期地盤平整和基礎設施工程 (道路工程)
MODIFICATION RESUMPTION PLAN
ROADS (WORKS, USE AND COMPENSATION) ORDINANCE (CHAPTER 370)
PWP ITEM No. 7747CL
ADVANCE SITE FORMATION AND ENGINEERING INFRASTRUCTURE WORKS AT
KWU TUNG NORTH NEW DEVELOPMENT AREA AND
FANLING NORTH NEW DEVELOPMENT AREA (ROAD WORKS)

檔案編號 File No.	LD_NDA/PLAN/2
測量圖編號 Survey Sheet No.	3-SW-7B
工程圖編號 Engineering Drg. No.	60335576/GZ1/108B (土木工程拓展署) (CEDD)
圖則編號 PLAN No.	DNM5102



圖例
LEGEND

收地 / 清拆界限
RESUMPTION / CLEARANCE LIMIT

將予收回的農地
AGRICULTURAL LAND TO BE RESUMED

刪除收地範圍
DELETION OF LAND RESUMPTION AREA

地段界線
LOT BOUNDARY

D.D. 丈量約份
DEMARCATIION DISTRICT

G.L. 政府土地
GOVERNMENT LAND

RP 餘段
REMAINING PORTION

S. 分段
SECTION

丈量約份界線
DEMARCATIION DISTRICT BOUNDARY

橙色綴黑網點
ORANGE STIPPLED BLACK

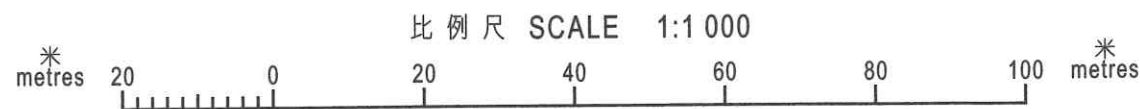
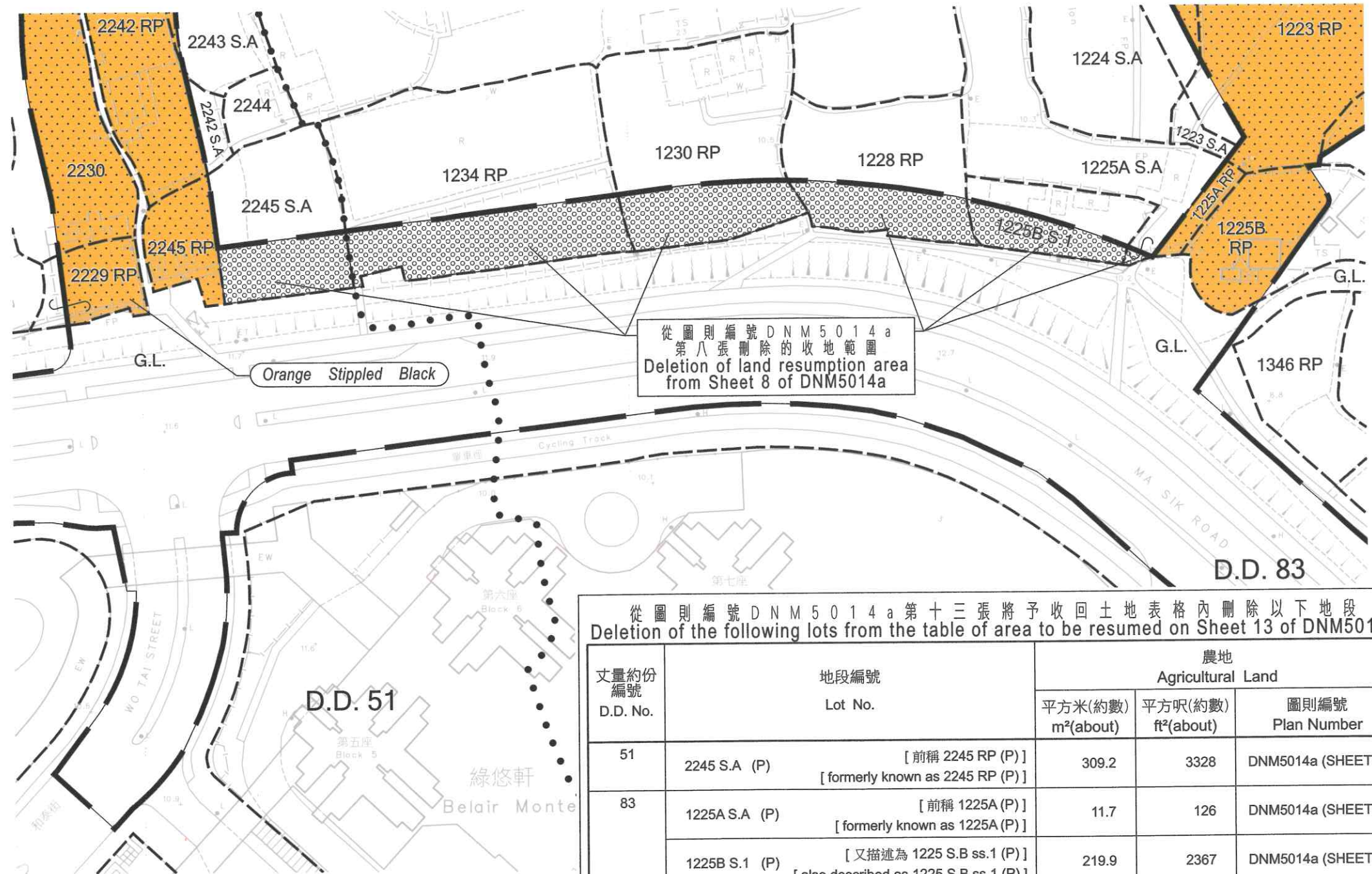

從圖則編號 DNM 5014 a 第十三張將予收回土地表格內刪除以下地段
Deletion of the following lots from the table of area to be resumed on Sheet 13 of DNM5014a

丈量約份 編號 D.D. No.	地段編號 Lot No.	農地 Agricultural Land		
		平方米(約數) m ² (about)	平方呎(約數) ft ² (about)	圖則編號 Plan Number
51	2245 S.A (P) [前稱 2245 RP (P)] [formerly known as 2245 RP (P)]	309.2	3328	DNM5014a (SHEET 8)
83	1225A S.A (P) [前稱 1225A (P)] [formerly known as 1225A (P)]	11.7	126	DNM5014a (SHEET 8)
	1225B S.1 (P) [又描述為 1225 S.B ss.1 (P)] [also described as 1225 S.B ss.1 (P)]	219.9	2367	DNM5014a (SHEET 8)
	1228 RP (P)	336.6	3623	DNM5014a (SHEET 8)
	1230 RP (P)	395.7	4259	DNM5014a (SHEET 8)
83	1234 RP (P)	648.1	6976	DNM5014a (SHEET 8)

將予收回的農地面積將減少 1921.2 平方米(約數) / 20679 平方呎(約數)
Area of agricultural land to be resumed will decrease by 1921.2 m² (about) / 20679 ft² (about)

只作識別用
FOR IDENTIFICATION PURPOSES ONLY

(趙莉莉 CHIU Lee-lee, Lily)
總產業測量師 / 土地徵用 Chief Estate Surveyor / Acquisition
日期 Date 21.9.2018

地政總署 工程項目組
Projects Section
Lands Department
圖則由測繪處工程項目測量小組繪製
Plan Prepared by Projects Survey Unit, Survey and Mapping Office
© 香港特別行政區政府 版權所有 Copyright reserved - Hong Kong SAR Government

修改收地圖則
道路 (工程、使用及補償) 條例 (第 370 章)
工務計劃項目第 7747CL 號
古洞北新發展區及粉嶺北新發展區
前期地盤平整和基礎設施工程 (道路工程)
MODIFICATION RESUMPTION PLAN
ROADS (WORKS, USE AND COMPENSATION) ORDINANCE (CHAPTER 370)
PWP ITEM No. 7747CL
ADVANCE SITE FORMATION AND ENGINEERING INFRASTRUCTURE WORKS AT
KWU TUNG NORTH NEW DEVELOPMENT AREA AND
FANLING NORTH NEW DEVELOPMENT AREA (ROAD WORKS)

檔案編號
File No. LD NDA/PLAN/2
測量圖編號
Survey Sheet No. 3-SW-7B & 8A
工程圖編號
Engineering Drg. No. 60335576/GZ1/109A (土木工程拓展署)
(CEDD)
圖則編號
PLAN No. DNM5126